

SPINNING REEL **8650HRL**

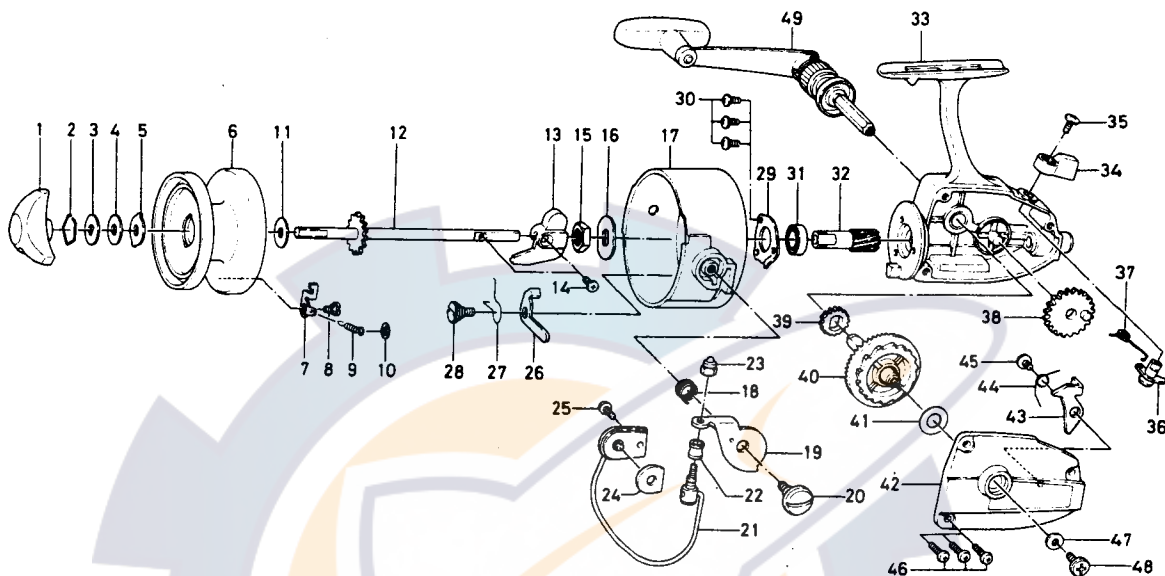

**KEY NO. 2 ~ 10**  
**6-734-2701**

**SPOOL ASSEMBLY**

Key No.	Parts No.	Parts Name	Key No.	Parts No.	Parts Name
1	6-005-1805	Drag knob	26	6-570-6821	Bail kick lever
2	6-170-4001	Drag washer retainer	27	6-140-6231	Bail kick lever spring
3	6-372-0801	Drag D washer	28	6-363-1501	Bail kick lever screw
4	6-370-6901	Disc washer	29	6-320-6201	Ball bearing ret. washer
5	6-375-5302	Drag A washer	30	6-351-6102	Ball bearing ret. washer screw
6	6-734-2601	Spool	31	6-635-5001	Ball bearing
7	6-030-6802	Spool click claw	32	6-401-4901	Pinion gear
8	6-363-8401	Spool click claw screw	33	6-700-0427	Body
9	6-140-2221	Spool click claw spring	34	6-540-3711	Anti-reverse lever
10	6-320-9701	Spool click claw spring retainer	35	6-350-1931	Anti-reverse lever screw
11	6-371-2731	Spool washer	36	6-460-6821	Anti-reverse cam
12	6-710-0711	Main shaft	37	6-142-2801	Anti-reverse cam spring
13	6-480-6911	Oscillating slider	38	6-412-1411	Oscillating gear
14	6-351-8901	Oscillating slider screw	39	6-401-1701	Oscillating pinion
15	6-340-8301	Rotor nut	40	6-412-1501	Drive gear
16	6-372-4901	Rotor retaining washer	41	6-370-7500	Drive gear washer
17	6-201-7314	Rotor	42	6-705-0215	Body cover
18	6-141-2801	Bail spring	43	6-110-8511	Anti-reverse claw
19	6-230-8411	Arm lever	44	6-142-8001	Anti-reverse claw spring
20	6-361-6413	Arm lever screw	45	6-350-2621	Anti-reverse claw screw
21	6-725-0231	Bail	46	6-351-8501	Body cover screw
22	6-250-2821	Line roller	47	6-371-9521	Handle washer
23	6-340-8501	Bail nut	48	6-351-3631	Handle screw
24	6-210-4301	Balancer	49	6-745-0541	Handle
25	6-351-6401	Bail holder screw			